

SONNE

Finestrat





Welcome to Your New Home



SONNE IS SUN
SONNE IS LIFE

INTRODUCING SONNE FINESTRAT

A new-build development on the Costa Blanca,
in **Finestrat**, just minutes away from the Sea.

Created for those who wish to enjoy the serenity
of Finestrat while staying close to the vibrant
lifestyle and the amenities of **Benidorm**.

SONNE

Your Home, Your Essence

A Home Where Tranquillity Meets Elegance.

SONNE FINESTRAT is an exclusive development featuring only **48 homes** across **four elegantly designed blocks**, set within a beautifully landscaped gated community.



Location

SONNE FINESTRAT enjoys a privileged location close to beautiful beaches, leisure destinations and iconic attractions, offering entertainment and activities for all ages.

Nearby, La Marina Shopping Centre stands out as one of the region's premier retail destinations, featuring a wide selection of fashion boutiques, restaurants, leisure facilities and essential services, as well as a hypermarket and cinema complex.

Just minutes away, Terra Mitica—one of Costa Blanca's most renowned theme parks—offers unforgettable experiences and has become a landmark for leisure and entertainment in the region.

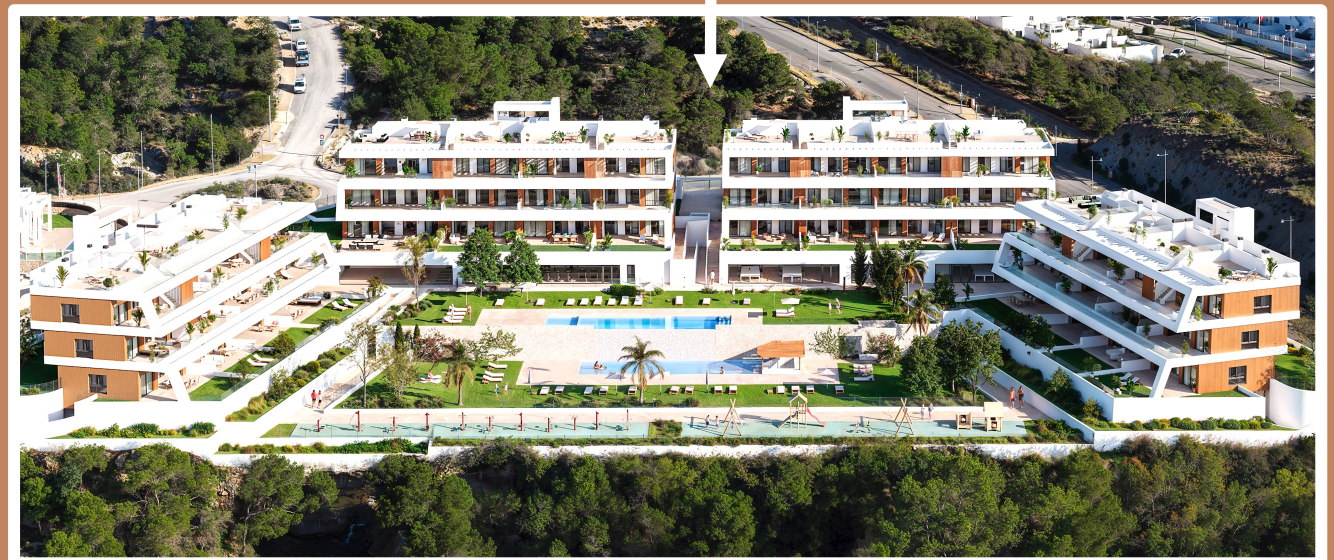

LOCATION: Calle de México, 31, 03509 Finestrat, Alicante



Experience Life on the Costa Blanca, Where Sun and Sea Shape Your Lifestyle

SONNE FINESTRAT enjoys a privileged location, close to Cala de **Finestrat** and the iconic Poniente Beach in **Benidorm**. Here, the calm of the Mediterranean Coast meets the lively atmosphere of the city, creating an exceptional lifestyle where sun, sea and sophistication come together.

More than a home, it is a private retreat designed for those who appreciate luxury, comfort and the perfect balance between leisure and everyday living.



Enjoy Mediterranean Lifestyle

With direct flights from major European capitals, Alicante Airport lies just 53 km away, the AVE high-speed rail and the AP-7 Mediterranean Motorway.

From charming historic streets and renowned golf courses to acclaimed gastronomy and golden beaches, every element of an exceptional Mediterranean lifestyle is effortlessly within reach.

A destination where elegance, authenticity and quality of life come together.





The **48 exclusive two and three bedrooms homes**, combine spacious interiors with large terraces of over **34 m²**, offering breathtaking views of the Mediterranean Sea, the Benidorm skyline, or the surrounding natural landscape.

Unique Homes

Choose from ground-floor homes with private gardens and swimming pools, bright first-floor apartments, or luxurious penthouses with chill-out terraces, designed for relaxing, entertaining, and soaking up the sun with spectacular views.

Every detail has been carefully crafted to deliver comfort, style, and the ultimate Mediterranean lifestyle.



The privilege of living above it all



A home designed to embrace natural light throughout the day

A spacious open-plan living and dining area with an integrated kitchen creates a modern, bright, and functional space, where every area flows naturally and opens directly onto the terrace, bringing the outdoors in.



Begin living the life you have always dreamed of

Your Moment, Your Space, Your Retreat

An exclusive master suite with en-suite bathroom, and private terrace: your personal sanctuary to enjoy natural light, privacy and ultimate comfort every day.





More space, more possibilities

A bright and versatile additional room, thoughtfully designed to adapt to your lifestyle, perfect as a children's bedroom, guest room, or elegant multi-purpose space.

Elegance and Natural Light Define Every Space

Beautifully designed homes created for modern living, featuring a generous living area that opens directly onto the terrace, allowing plenty of natural light while enhancing the sense of openness.

The open-plan kitchen is harmoniously integrated, creating a stylish yet practical setting, perfect for both everyday living. The principal bedroom benefits from an en-suite bathroom, providing an added touch of comfort and privacy.





Exclusive living with views over the Mediterranean

Where Social Living Meets Tranquillity

The communal areas have been carefully curated to balance vibrant social living with moments of calm and relaxation. At the heart of the development, two elegant cascading swimming pools connect smoothly with the exclusive Friends Pool Bar — a refined setting to unwind, meet neighbours or enjoy relaxed moments with friends under the Mediterranean sun.

Surrounding these spaces, beautifully landscaped gardens create generous multi-purpose areas designed for everyday enjoyment — whether for a quiet stroll, reading in the shade or simply embracing the Mediterranean climate. A setting designed to let you live at your own rhythm, where privacy, comfort and wellbeing come together to create an exceptional lifestyle.





Enhance Everyday Wellbeing

A curated selection of amenities allows you to enjoy each day at your own pace.

From social spaces and shared experiences to a private gym and co-working area, every detail has been designed to support a balanced lifestyle.

Outdoor areas encourage activity in the fresh Mediterranean air, while each home includes private parking with pre-installation for electric vehicle charging and a convenient private storage room.



Cascading Pools and Poolside Bar



Social Lounge



Coworking



Multi-purpose Spaces



Gym



Sauna



Outdoor children's Play area



Gourmet Social Lounge



Parking and Storage room



Where spaces connect and moments endure



A Home, Beautifully Prepared from Day One

At **SONNE FINESTRAT** you have the option to enjoy a fully curated interior design and furnishing service by **ECCO STUDIO**, where every element has been carefully selected to create a refined and harmonious living environment.

From the moment you step inside, your home can be presented completely styled and ready to enjoy, with elegant furniture, sophisticated décor and thoughtfully chosen accessories that reflect a relaxed Mediterranean lifestyle. Each space is designed to feel effortlessly welcoming and perfectly balanced, tailored to complement your taste and lifestyle.

A home created with **exceptional attention to detail**, allowing you to arrive, settle in and begin enjoying your new life from the very first day, with nothing left to do but relax and make it your own.

Decoration by:

e c c o
S t u d i o



Your Retreat on the Costa Blanca

At SONNE Finestrat, Light,
Tranquillity and Wellbeing
Come Together to
Create a Refined Sense
of Community.

A place designed to be lived
and **enjoyed every day.**



SONNE *Finestrat*

BUILDING SPECIFICATIONS



Foundations and Structure

Reinforced concrete columns and waffle slabs. Structure reinforced to allow the installation of a Jacuzzi on the solarium.



Roof

Solarium roofs will be flat and walkable, with thermal insulation in extruded polystyrene and waterproofed with a double-layer membrane, finished with non-slip ceramic tiles laid with low-shrinkage cement mortar on a screed suitable for outdoor use. Roofs designated for installations will have the same configuration as the solarium roof; however, they will not be walkable and will be finished with gravel.



Facade

Ceramic facade with a scraped and painted monocouche render finish, incorporating ceramic cladding in selected areas. Load-bearing wall in ceramic brickwork or blockwork, according to project specifications. Continuous thermal insulation within the cavity. Laminated glass balustrades.



Interior Partition Walls

Party walls between properties formed by double ceramic brickwork with acoustic insulation and plasterboard lining on both sides. Internal partitions formed by plasterboard system on galvanised steel profiles with intermediate insulation. Finished in paint or ceramic tiling, as appropriate.



External Joinery

PVC window frames with double glazing and air chamber (Climalit type). Low-emissivity glazing with solar control (Guardian Sun type). Motorised blinds in the living room.



Internal Joinery

Armoured front entrance door with anti-bumping lock. Lacquered finish internally and panelled externally. Stainless steel handles. Lacquered wooden internal doors. Fully lined fitted wardrobes with drawer units and hanging rails.



Kitchen

Fully fitted kitchen with contemporary wall and base units featuring concealed handles. Soft-closing drawers and cupboard doors. Full-extension drawers with cushioned closing system. "Neolith" worktop or similar, with undermounted stainless steel sink and single-lever mixer tap. Integrated appliances included.



Bathroom

Vitrified porcelain sanitaryware. Single-lever mixer taps. Large-format extra-flat resin shower trays. 6 mm toughened glass shower screens. Wall-mounted vanity units.



Flooring and Finishes

Large-format porcelain floor tiles throughout the property, with C2-rated non-slip porcelain tiles on terraces. Bathroom walls finished with ceramic tiling. Internal vertical surfaces finished with smooth plastic emulsion paint. Suspended ceilings throughout the property. Terrace ceilings partially finished with rendered mortar coating.



Air Conditioning and Comfort

Individual ducted air conditioning system, including hot and cold unit. Individual aérothermal system for domestic hot water. Pre-installation for Jacuzzi on the solarium.



Electrical Installation and Telecommunications

High-quality electrical fittings and mechanisms. Recessed LED lighting. Fibre optic installation with RJ45 data points in the living room and all bedrooms. TV points in bedrooms, living room, terrace and solarium. Communal TV aerial and satellite dish installation with reception of international channels. Video entry system at the main access.



Residential Development

Fully enclosed gated development. Two communal swimming pools with separate adult and children's areas. Sun loungers and parasols in the pool area. C3-rated non-slip porcelain flooring in wet areas. Spacious landscaped communal gardens. Children's play area. Outdoor calisthenics and sports area. External LED lighting. Fitness Area with raised technical flooring and cardio and strength-training equipment by "NordicTrack" or similar. Multi-purpose room with raised flooring and mirrored wall. Wellness Facilities (Sauna) with shower and changing room. Modern coworking space. Gourmet room fully equipped with kitchen, appliances and event furniture.



Parking and Storage Rooms

Garage access via automatic door operated by remote control. Communal garage finished in polished concrete. Pre-installation for electric vehicle charging point.



Extras

Choice of kitchen colours: units and worktop. Jacuzzi. Three colour finish options for flooring, walls and bathrooms. Home automation system.

** The information contained in this Quality Specification is provided for guidance purposes only. The developer reserves the right to modify the project's features, materials, layout, surfaces and design elements due to technical, administrative or project management requirements, without this implying any reduction in the overall quality standards.*



Energy Rating: B

SONNE Finestrat Typical Floor Plans



SONNE *Finestrat*

SONNE FINESTRAT features **48** exclusive homes, thoughtfully distributed across **four architecturally designed buildings** within a private gated enclave.

The outdoor spaces reveal a carefully landscaped environment with lush gardens, shaded pergolas, children's play areas and outdoor fitness zones, designed to enhance both relaxation and active living.

A setting created to combine privacy, wellbeing and an exceptional quality of life.



GROUND FLOOR

2 BEDROOMS

Internal Built Area: 66,70 m²

Terrace: 37 m²

TOTAL BUILT AREA: 103,70 m²

GARDEN: 38,30 m²



GROUND FLOOR

3 BEDROOMS

Internal Built Area: 66,70 m²

Terrace: 51,30 m²

TOTAL BUILT AREA: 100,70 m²

GARDEN: 63,20 m²



GROUND FLOOR+ POOL

3 BEDROOMS

Internal Built Area : 88,40 m²

Terrace: 51,30 m²

TOTAL BUILT AREA: 139,70 m²

GARDEN: 218,20 m²



FIRST FLOOR

2 BEDROOMS

Internal Built Area: 66,70 m²

Terrace: 34 m²

TOTAL BUILT AREA: 100,70 m²



FIRST FLOOR

3 BEDROOMS

Internal Built Area: 88,40 m²

Terrace: 47,30 m²

TOTAL BUILT AREA: 135,60 m²



PENTHOUSE + SOLARIUM

2 BEDROOMS

Internal Built Area: 67,20 m²

Terrace: 31,80 m²

TOTAL BUILT AREA: 99,00 m²

Private Solarium: 48,40 m²



PENTHOUSE + SOLARIUM

3 BEDROOMS

Internal Built Area: 89,30 m²

Terrace: 44,80 m²

TOTAL BUILT AREA: 134,10 m²

Private Solarium: 65,60 m²

COMMUNAL AREAS

MULTI- PURPOSE

GYM

SAUNA

"THE LIBRARY"

GOURMET LOUNGE

COWORKING

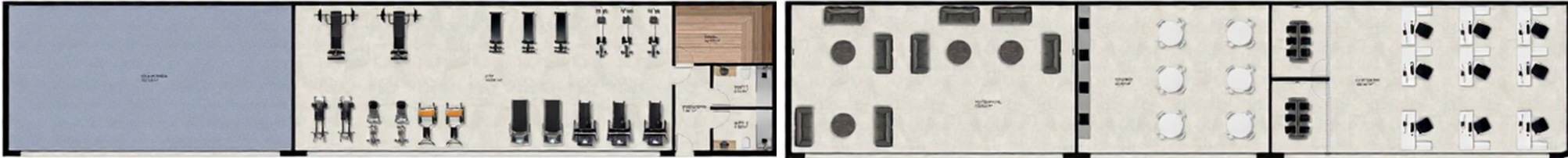

CASCADING POOLS & POOLSIDE BAR

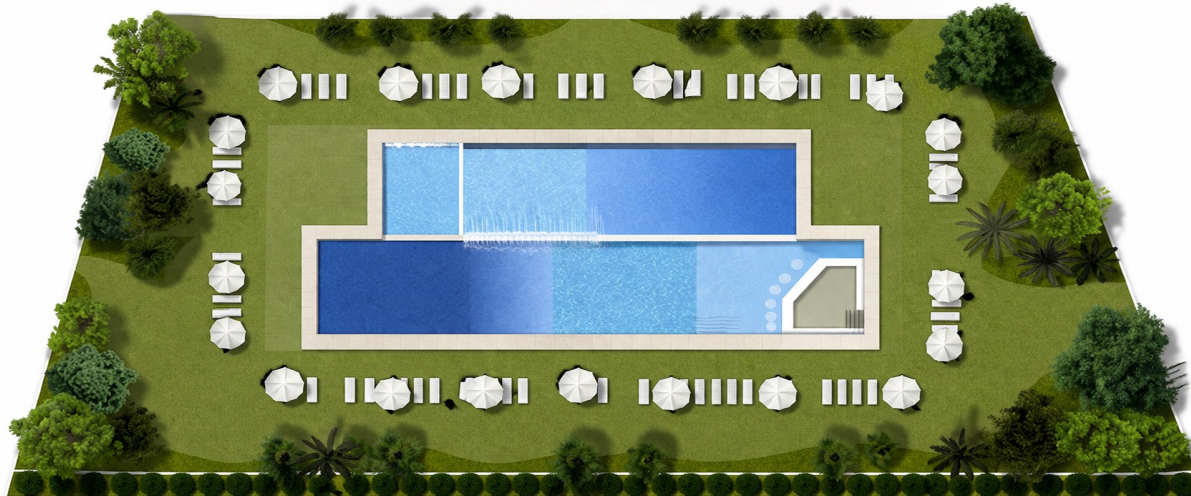

OUTDOOR GYM

OUTDOOR CHILDREN'S PLAY AREA

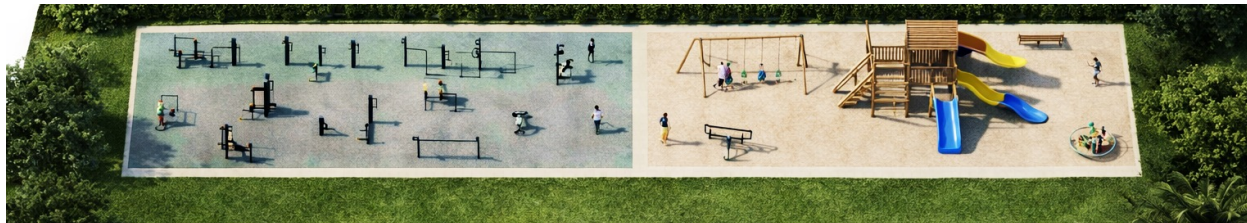

SONNE

Finestrat

This Is Where Life Shines. This Is Your Place



Discover **SONNE FINESTRAT** a residential development, where Mediterranean light enhances every space and elevates everyday living.



**SONNE IS SUN,
SONNE IS LIFE**



SONNE *Finestrat*

S O N N E

SONNE INVESTMENTS is a fully integrated real estate investment and development firm, supported by a highly experienced team with over **30 years of expertise** and an outstanding, well-established track record in delivering exceptional residential and commercial projects.

www.sonneinvest.com

DISCLAIMER

The information contained in this brochure, including texts, plans, infographics, renders, images, prices, floor areas and any other graphic or descriptive material, is provided for guidance and information purposes only. Under no circumstances shall it be considered a contractual offer or a legally binding document. Project specifications, including materials, quality standards, layouts, dimensions and design, may be subject to change due to technical, administrative or regulatory requirements, or at the discretion of the developer or project management team, without implying any reduction in the intended quality standards. The marketing and sale of the properties are subject to the granting of the relevant planning permissions and statutory approvals, as well as the formal execution of the corresponding private purchase contract, in accordance with applicable legislation. All images and graphic representations included in this brochure are computer-generated visualisations and may not correspond exactly to the final built product. Furniture, decorative elements and landscaping shown are for illustrative purposes only and are not included as part of the property unless expressly stated otherwise.

