

SONNE Finestrat Typical Floor Plans



SONNE *Finestrat*

SONNE FINESTRAT features **48** exclusive homes, thoughtfully distributed across **four architecturally designed buildings** within a private gated enclave.

The outdoor spaces reveal a carefully landscaped environment with lush gardens, shaded pergolas, children's play areas and outdoor fitness zones, designed to enhance both relaxation and active living.

A setting created to combine privacy, wellbeing and an exceptional quality of life.



GROUND FLOOR

2 BEDROOMS

Internal Built Area: 66,70 m²

Terrace: 37 m²

TOTAL BUILT AREA: 103,70 m²

GARDEN: 38,30 m²

PRICES FROM: : €375,000



GROUND FLOOR

3 BEDROOMS

Internal Built Area: 66,70 m²

Terrace: 51,30 m²

TOTAL BUILT AREA: 100,70 m²

GARDEN: 63,20 m²

PRICES FROM: : €568,000



GROUND FLOOR+ POOL

3 BEDROOMS

Internal Built Area : 88,40 m²

Terrace: 51,30 m²

TOTAL BUILT AREA: 139,70 m²

GARDEN: 218,00 m²

PRICES FROM : : €613.000



FIRST FLOOR

2 BEDROOMS

Internal Built Area: 66,70 m²

Terrace: 34 m²

TOTAL BUILT AREA: 100,70 m²

PRICES FROM: : €355.000



FIRST FLOOR

3 BEDROOMS

Internal Built Area: 88,40 m²

Terrace: 47,30 m²

TOTAL BUILT AREA: 135,70 m²

PRICES FROM: €442.000



PENTHOUSE + SOLARIUM

2 BEDROOMS

Internal Built Area: 67,20 m²

Terrace: 31,80 m²

TOTAL BUILT AREA: 99,00 m²

Private Solarium: 48,40 m²

PRICES FROM: : €470.000



PENTHOUSE + SOLARIUM

3 BEDROOMS

Internal Built Area: 89,30 m²

Terrace: 44,80 m²

TOTAL BUILT AREA: 134,10 m²

Private Solarium: 65,60 m²

PRICES FROM: : €608.000

COMMUNAL AREAS

MULTI- PURPOSE

GYM

SAUNA

"THE LIBRARY"

GOURMET LOUNGE

COWORKING

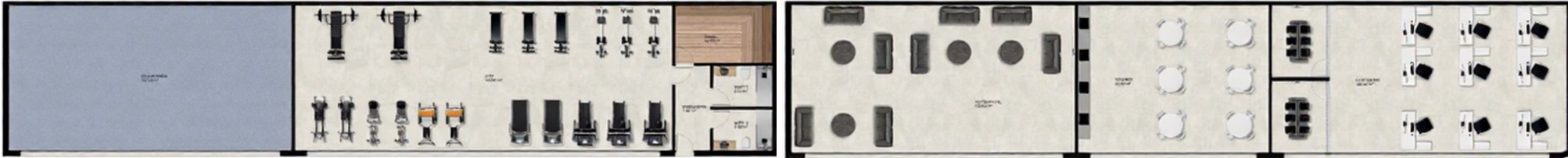

CASCADING POOLS & POOLSIDE BAR

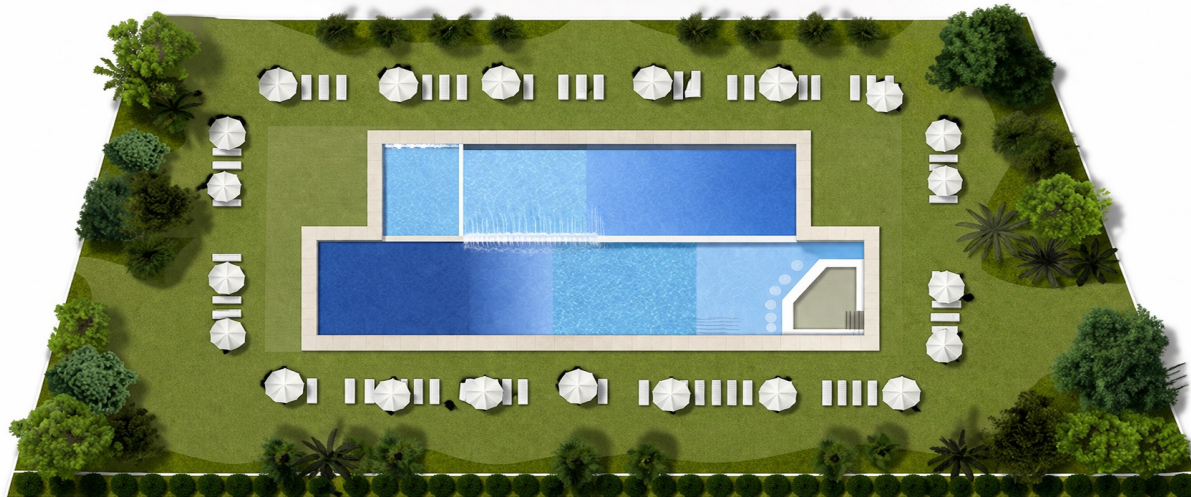

OUTDOOR GYM

OUTDOOR CHILDREN'S PLAY AREA

